

| REVISION HISTORY | | | | |
|------------------|-------------------|-----------|----|---------|
| REV | DESCRIPTION | DATE | BY | CHECKED |
| A | ISSUED FOR REVIEW | 3/11/2025 | JR | JLL |

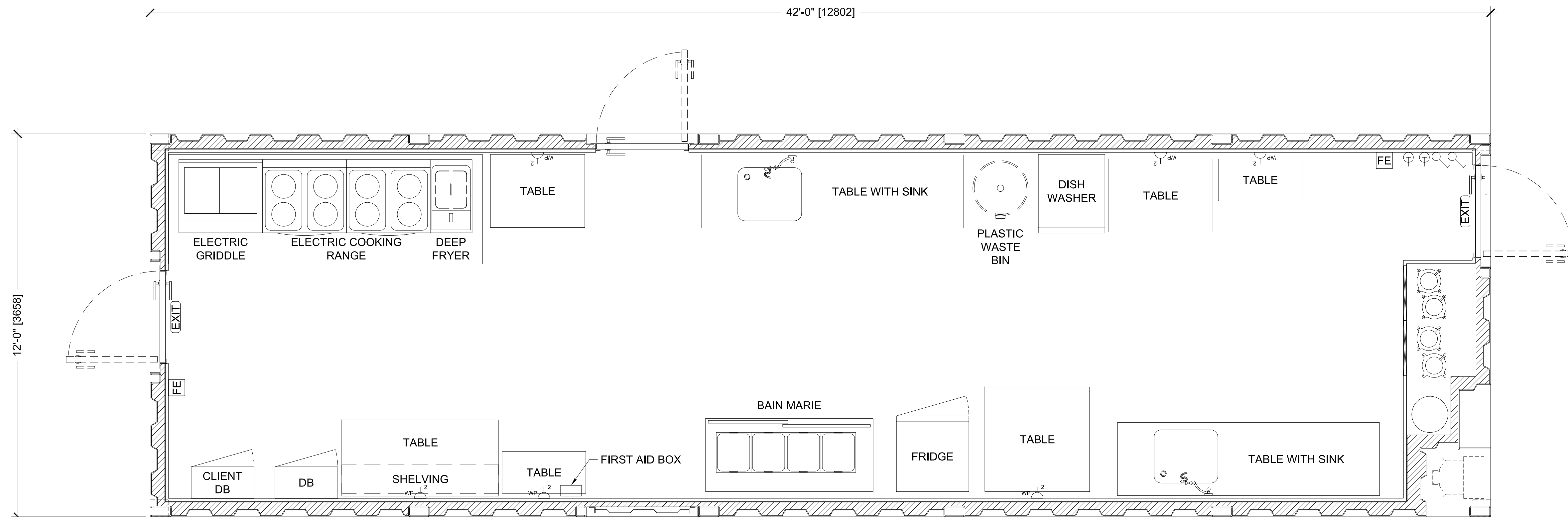

THE INFORMATION CONTAINED HEREIN IS PROPRIETARY TO REDGUARD, LLC AND SHALL NOT BE REPRODUCED OR DISCLOSED IN WHOLE OR IN PART OR USED FOR ANY PURPOSE EXCEPT WHEN SUCH USER POSSESSES DIRECT WRITTEN AUTHORIZATION FROM REDGUARD, LLC

EXPORT CONTROLLED DATA: THIS DOCUMENT MAY CONTAIN TECHNICAL INFORMATION WHOSE EXPORT IS GOVERNED BY THE UNITED STATES DEPARTMENTS OF COMMERCE AND STATE. IT IS THE RESPONSIBILITY OF THE RECIPIENT(S) OF THIS DRAWING TO ENSURE THAT ITS CONTENTS ARE CONTROLLED AS SUCH TO REMAIN IN COMPLETE COMPLIANCE WITH THE U.S. ARMS EXPORT CONTROL ACT, THE INTERNATIONAL TRAFFIC IN ARMS REGULATIONS, AND THE EXPORT ADMINISTRATION ACT.



ARMODA

4817 S LEWIS ST.
 NEW IBERIA, LA 70560
 PH: 504.588.2551
www.armoda.com

HYDRA SUBSEA

12' X 42' X 10'-6"

FLOOR PLAN

CP#: A-025

PROJECT MANAGER: JO

DRAWN BY: JR

DATE: 3/11/2025

FILE: A-025 12X42 FP

SCALE: 1/2" = 1'-0"

REVISION: A

SHEET: A1.1

**A-025 HYDRA SUBSEA
 GALLEY FLOOR PLAN - Q# 300103
 12' X 42' X 10'-6"**

**SCALE LISTED IS VALID
 ONLY FOR "D" SIZE PAPER
 (36" X 24")**

| REVISION HISTORY | | | | |
|------------------|-------------------|-----------|----|---------|
| REV | DESCRIPTION | DATE | BY | CHECKED |
| A | ISSUED FOR REVIEW | 3/11/2025 | JR | JLL |

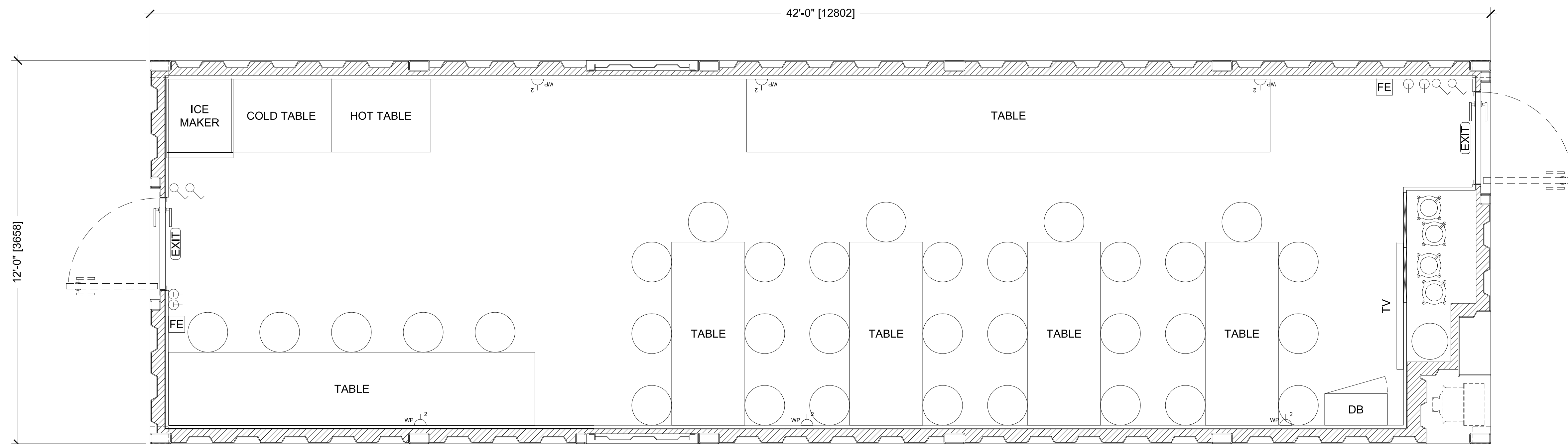

THE INFORMATION CONTAINED HEREIN IS PROPRIETARY TO REDGUARD, LLC AND SHALL NOT BE REPRODUCED OR DISCLOSED IN WHOLE OR IN PART OR USED FOR ANY PURPOSE EXCEPT WHEN SUCH USER POSSESSES DIRECT WRITTEN AUTHORIZATION FROM REDGUARD, LLC

EXPORT CONTROLLED DATA: THIS DOCUMENT MAY CONTAIN TECHNICAL INFORMATION WHOSE EXPORT IS GOVERNED BY THE UNITED STATES DEPARTMENTS OF COMMERCE AND STATE. IT IS THE RESPONSIBILITY OF THE RECIPIENT(S) OF THIS DRAWING TO ENSURE THAT ITS CONTENTS ARE CONTROLLED AS SUCH TO REMAIN IN COMPLETE COMPLIANCE WITH THE U.S. ARMS EXPORT CONTROL ACT, THE INTERNATIONAL TRAFFIC IN ARMS REGULATIONS, AND THE EXPORT ADMINISTRATION ACT.



4817 S LEWIS ST.
 NEW IBERIA, LA 70560
 PH: 504.588.2551
www.armoda.com

HYDRA SUBSEA
 12' X 42' X 10'-6"
 FLOOR PLAN

CP#: A-025
 PROJECT MANAGER: JO
 DRAWN BY: JR
 DATE: 3/11/2025
 FILE: A-025 12X42 FP
 SCALE: 1/2" = 1'-0"
 REVISION: A
 SHEET: A1.2

**A-025 HYDRA SUBSEA
 DINER FLOOR PLAN - Q# 300103
 12' X 42' X 10'-6"**

**SCALE LISTED IS VALID
 ONLY FOR "D" SIZE PAPER
 (36" X 24")**

| REVISION HISTORY | | | | |
|------------------|-------------------|-----------|----|---------|
| REV | DESCRIPTION | DATE | BY | CHECKED |
| A | ISSUED FOR REVIEW | 3/11/2025 | JR | JLL |

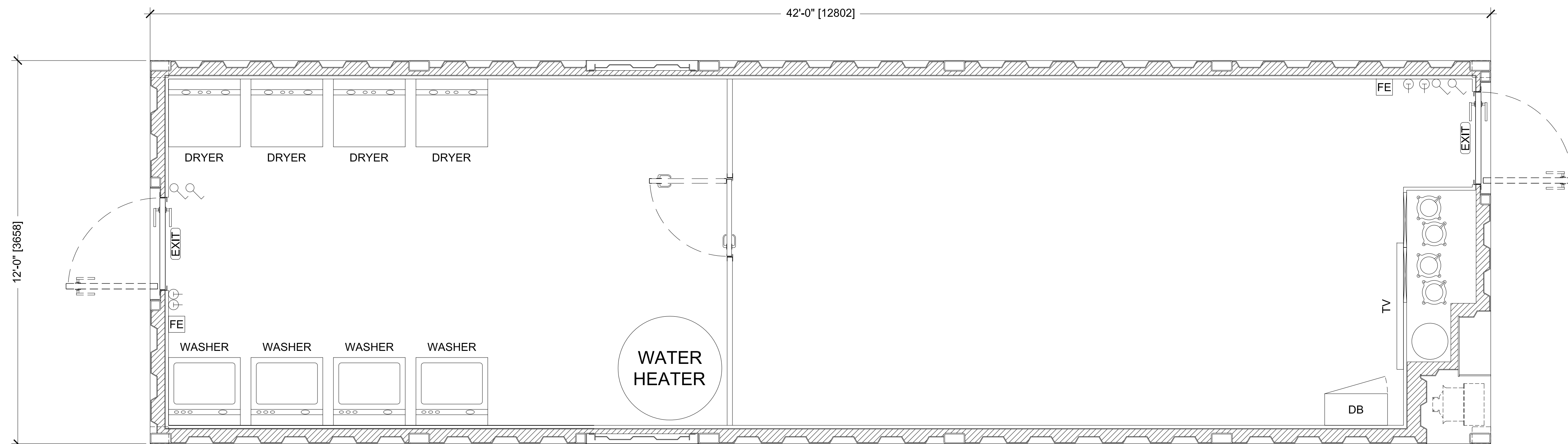

THE INFORMATION CONTAINED HEREIN IS PROPRIETARY TO REDGUARD, LLC AND SHALL NOT BE REPRODUCED OR DISCLOSED IN WHOLE OR IN PART OR USED FOR ANY PURPOSE EXCEPT WHEN SUCH USER POSSESSES DIRECT WRITTEN AUTHORIZATION FROM REDGUARD, LLC

EXPORT CONTROLLED DATA: THIS DOCUMENT MAY CONTAIN TECHNICAL INFORMATION WHOSE EXPORT IS GOVERNED BY THE UNITED STATES DEPARTMENTS OF COMMERCE AND STATE. IT IS THE RESPONSIBILITY OF THE RECIPIENT(S) OF THIS DRAWING TO ENSURE THAT ITS CONTENTS ARE CONTROLLED AS SUCH TO REMAIN IN COMPLETE COMPLIANCE WITH THE U.S. ARMS EXPORT CONTROL ACT, THE INTERNATIONAL TRAFFIC IN ARMS REGULATIONS, AND THE EXPORT ADMINISTRATION ACT.



4817 S LEWIS ST.
 NEW IBERIA, LA 70560
 PH: 504.588.2551
 www.armoda.com

HYDRA SUBSEA

12' X 42' X 10'-6"

FLOOR PLAN

CP#: A-025

PROJECT MANAGER: JO

DRAWN BY: JR

DATE: 3/11/2025

FILE: A-025 12X42 FP

SCALE: 1/2" = 1'-0"

REVISION: A

SHEET: A1.3

**A-025 HYDRA SUBSEA
 WOMEN'S LOCKER / LAUNDRY FLOOR PLAN - Q# 300103
 12' X 42' X 10'-6"**

**SCALE LISTED IS VALID
 ONLY FOR "D" SIZE PAPER
 (36" X 24")**

| REVISION HISTORY | | | | |
|------------------|-------------------|-----------|----|---------|
| REV | DESCRIPTION | DATE | BY | CHECKED |
| A | ISSUED FOR REVIEW | 3/11/2025 | JR | JLL |

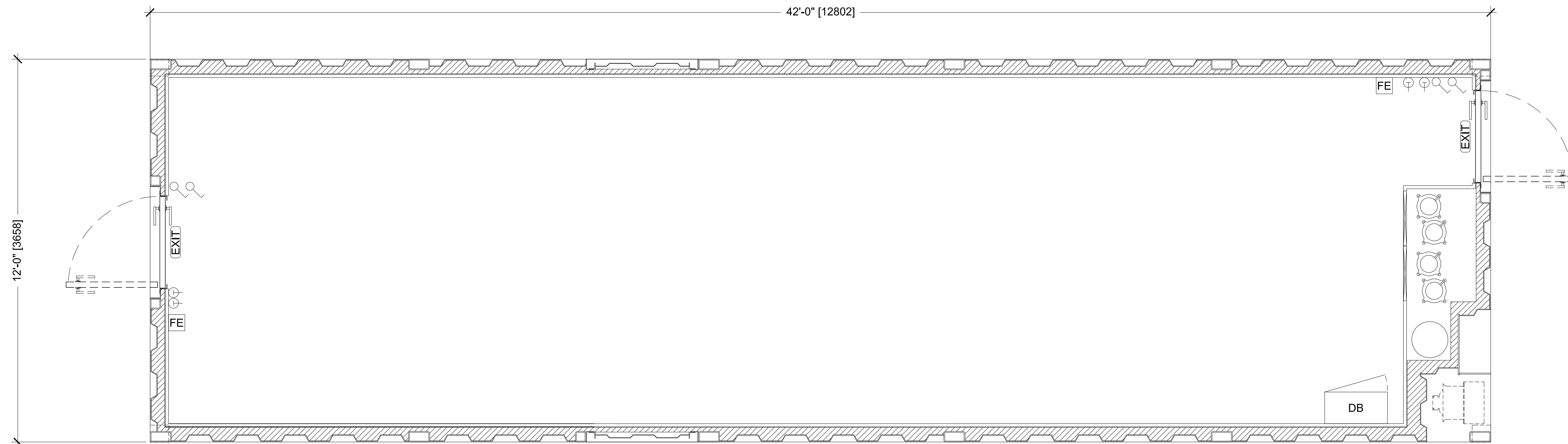

THE INFORMATION CONTAINED HEREIN IS PROPRIETARY TO REDGUARD, LLC AND SHALL NOT BE REPRODUCED OR DISCLOSED IN WHOLE OR IN PART OR USED FOR ANY PURPOSE EXCEPT WHEN SUCH USER POSSESSES DIRECT WRITTEN AUTHORIZATION FROM REDGUARD, LLC

EXPORT CONTROLLED DATA: THIS DOCUMENT MAY CONTAIN TECHNICAL INFORMATION WHOSE EXPORT IS GOVERNED BY THE UNITED STATES DEPARTMENTS OF COMMERCE AND STATE. IT IS THE RESPONSIBILITY OF THE RECIPIENT(S) OF THIS DRAWING TO ENSURE THAT ITS CONTENTS ARE CONTROLLED AS SUCH TO REMAIN IN COMPLETE COMPLIANCE WITH THE U.S. ARMS EXPORT CONTROL ACT, THE INTERNATIONAL TRAFFIC IN ARMS REGULATIONS, AND THE EXPORT ADMINISTRATION ACT.

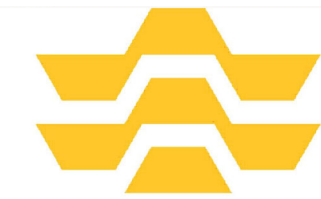

ARMODA

4817 S LEWIS ST.
 NEW IBERIA, LA 70560
 PH: 504.588.2551
www.armoda.com

HYDRA SUBSEA

12' X 42' X 10'-6"

FLOOR PLAN

CP#: A-025

PROJECT MANAGER: JO

DRAWN BY: JR

DATE: 3/11/2025

FILE: A-025 12X42 FP

SCALE: 1/2" = 1'-0"

REVISION: A

SHEET: A1.4

**A-025 HYDRA SUBSEA
 MEN'S LOCKER FLOOR PLAN - Q# 300103
 12' X 42' X 10'-6"**

**SCALE LISTED IS VALID
 ONLY FOR "D" SIZE PAPER
 (36" X 24")**

| REVISION HISTORY | | | | |
|------------------|-------------------|-----------|----|---------|
| REV | DESCRIPTION | DATE | BY | CHECKED |
| A | ISSUED FOR REVIEW | 3/11/2025 | JR | JLL |

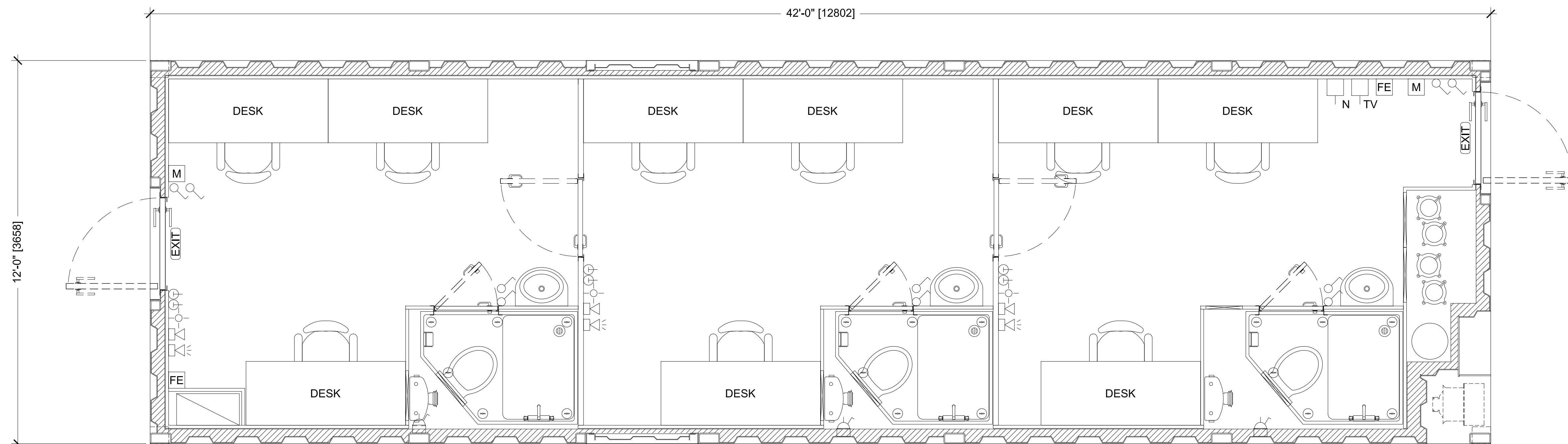

THE INFORMATION CONTAINED HEREIN IS PROPRIETARY TO REDGUARD, LLC AND SHALL NOT BE REPRODUCED OR DISCLOSED IN WHOLE OR IN PART OR USED FOR ANY PURPOSE EXCEPT WHEN SUCH USER POSSESSES DIRECT WRITTEN AUTHORIZATION FROM REDGUARD, LLC

EXPORT CONTROLLED DATA: THIS DOCUMENT MAY CONTAIN TECHNICAL INFORMATION WHOSE EXPORT IS GOVERNED BY THE UNITED STATES DEPARTMENTS OF COMMERCE AND STATE. IT IS THE RESPONSIBILITY OF THE RECIPIENT(S) OF THIS DRAWING TO ENSURE THAT ITS CONTENTS ARE CONTROLLED AS SUCH TO REMAIN IN COMPLETE COMPLIANCE WITH THE U.S. ARMS EXPORT CONTROL ACT, THE INTERNATIONAL TRAFFIC IN ARMS REGULATIONS, AND THE EXPORT ADMINISTRATION ACT.



4817 S LEWIS ST.
 NEW IBERIA, LA 70560
 PH: 504.588.2551
www.armoda.com

HYDRA SUBSEA

12' X 42' X 10'-6"

FLOOR PLAN

CP#: A-025

PROJECT MANAGER: JO

DRAWN BY: JR

DATE: 3/11/2025

FILE: A-025 12X42 FP

SCALE: 1/2" = 1'-0"

REVISION: A

SHEET: A1.5

**A-025 HYDRA SUBSEA
 OFFICE FLOOR PLAN - Q# 300103
 12' X 42' X 10'-6"**

**SCALE LISTED IS VALID
 ONLY FOR "D" SIZE PAPER
 (36" X 24")**

| REVISION HISTORY | | | | |
|------------------|-------------------|-----------|----|---------|
| REV | DESCRIPTION | DATE | BY | CHECKED |
| A | ISSUED FOR REVIEW | 3/11/2025 | JR | JLL |

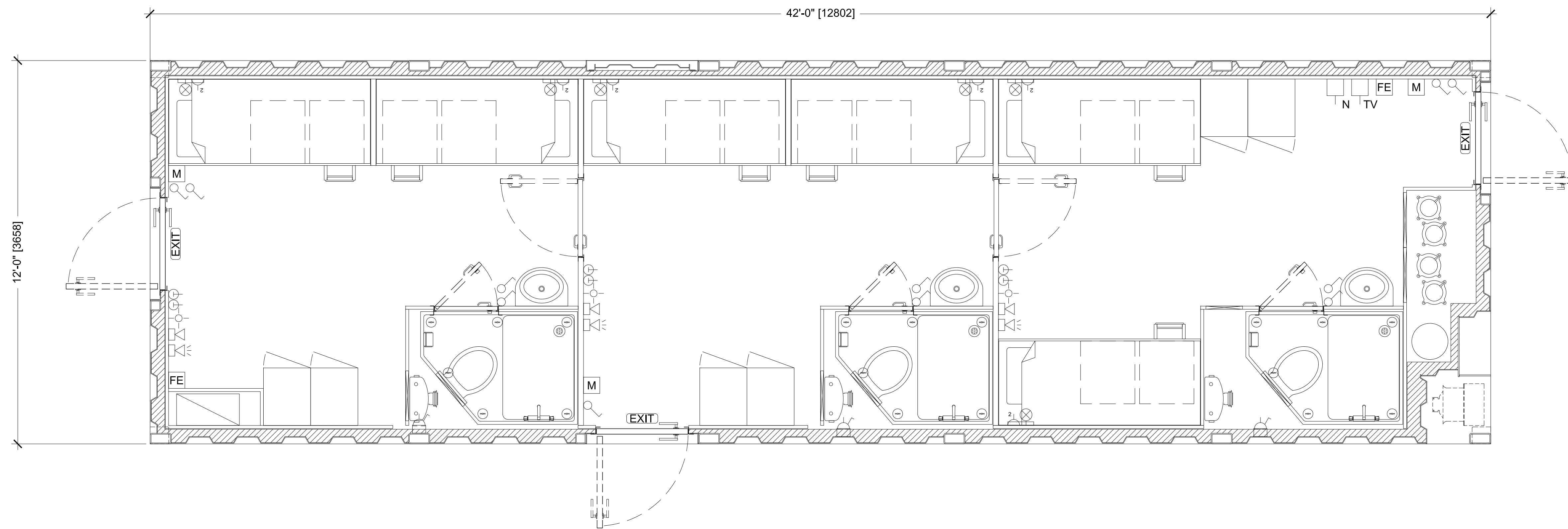

THE INFORMATION CONTAINED HEREIN IS PROPRIETARY TO REDGUARD, LLC AND SHALL NOT BE REPRODUCED OR DISCLOSED IN WHOLE OR IN PART OR USED FOR ANY PURPOSE EXCEPT WHEN SUCH USER POSSESSES DIRECT WRITTEN AUTHORIZATION FROM REDGUARD, LLC

EXPORT CONTROLLED DATA: THIS DOCUMENT MAY CONTAIN TECHNICAL INFORMATION WHOSE EXPORT IS GOVERNED BY THE UNITED STATES DEPARTMENTS OF COMMERCE AND STATE. IT IS THE RESPONSIBILITY OF THE RECIPIENT(S) OF THIS DRAWING TO ENSURE THAT ITS CONTENTS ARE CONTROLLED AS SUCH TO REMAIN IN COMPLETE COMPLIANCE WITH THE U.S. ARMS EXPORT CONTROL ACT, THE INTERNATIONAL TRAFFIC IN ARMS REGULATIONS, AND THE EXPORT ADMINISTRATION ACT.



4817 S LEWIS ST.
 NEW IBERIA, LA 70560
 PH: 504.588.2551
www.armoda.com

HYDRA SUBSEA
 12' X 42' X 10'-6"
 FLOOR PLAN

CP#: A-025
 PROJECT MANAGER: JO
 DRAWN BY: JR
 DATE: 3/11/2025
 FILE: A-025 12X42 FP
 SCALE: 1/2" = 1'-0"
 REVISION: A
 SHEET: A1.6

**A-025 HYDRA SUBSEA
 ACCOMMODATION FLOOR PLAN - Q# 300103
 12' X 42' X 10'-6"**

**SCALE LISTED IS VALID
 ONLY FOR "D" SIZE PAPER
 (36" X 24")**

| REVISION HISTORY | | | | |
|------------------|-------------------|-----------|----|---------|
| REV | DESCRIPTION | DATE | BY | CHECKED |
| A | ISSUED FOR REVIEW | 3/11/2025 | JR | JLL |

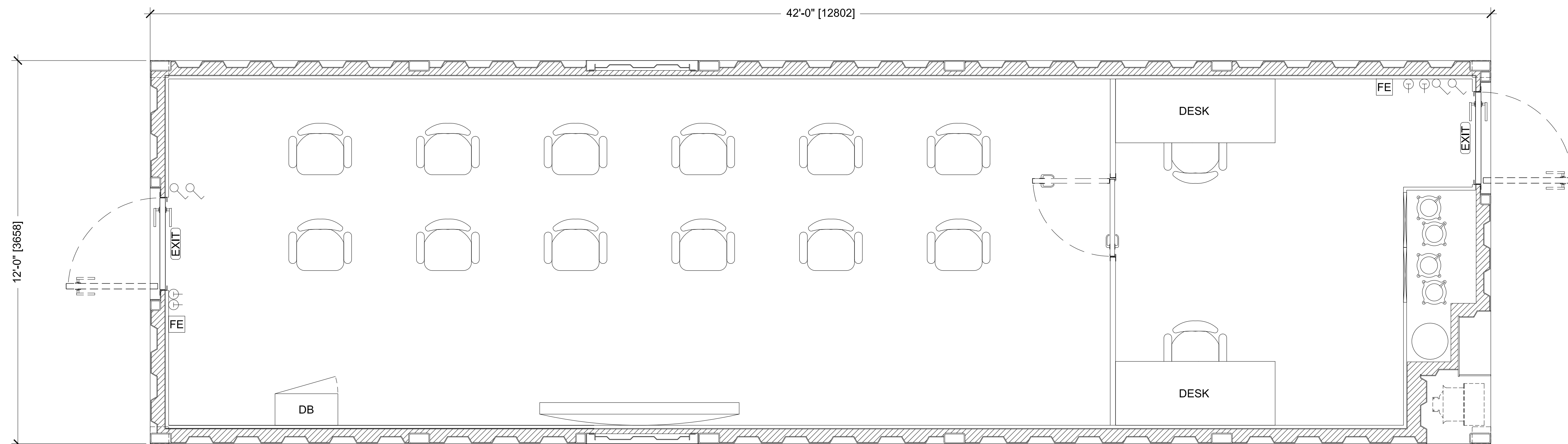

THE INFORMATION CONTAINED HEREIN IS PROPRIETARY TO REDGUARD, LLC AND SHALL NOT BE REPRODUCED OR DISCLOSED IN WHOLE OR IN PART OR USED FOR ANY PURPOSE EXCEPT WHEN SUCH USER POSSESSES DIRECT WRITTEN AUTHORIZATION FROM REDGUARD, LLC

EXPORT CONTROLLED DATA: THIS DOCUMENT MAY CONTAIN TECHNICAL INFORMATION WHOSE EXPORT IS GOVERNED BY THE UNITED STATES DEPARTMENTS OF COMMERCE AND STATE. IT IS THE RESPONSIBILITY OF THE RECIPIENT(S) OF THIS DRAWING TO ENSURE THAT ITS CONTENTS ARE CONTROLLED AS SUCH TO REMAIN IN COMPLETE COMPLIANCE WITH THE U.S. ARMS EXPORT CONTROL ACT, THE INTERNATIONAL TRAFFIC IN ARMS REGULATIONS, AND THE EXPORT ADMINISTRATION ACT.



4817 S LEWIS ST.
 NEW IBERIA, LA 70560
 PH: 504.588.2551
www.armoda.com

HYDRA SUBSEA

12' X 42' X 10'-6"

FLOOR PLAN

CP#: A-025

PROJECT MANAGER: JO

DRAWN BY: JR

DATE: 3/11/2025

FILE: A-025 12X42 FP

SCALE: 1/2" = 1'-0"

REVISION: A

SHEET: A1.7

**A-025 HYDRA SUBSEA
 REC. ROOM FLOOR PLAN - Q# 300103
 12' X 42' X 10'-6"**

**SCALE LISTED IS VALID
 ONLY FOR "D" SIZE PAPER
 (36" X 24")**