

REVISION HISTORY				
REV	DESCRIPTION	DATE	BY	CHECKED
A	ISSUED FOR REVIEW	9/9/2025	JR	ACK

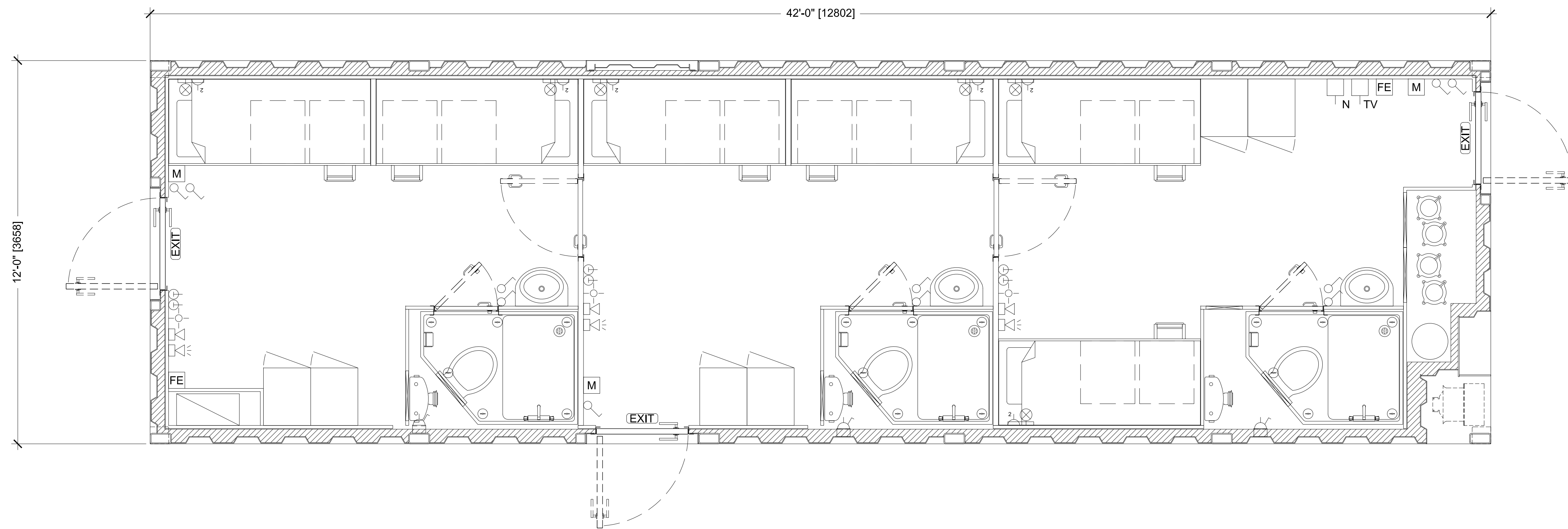

THE INFORMATION CONTAINED HEREIN IS PROPRIETARY TO REDGUARD, LLC AND SHALL NOT BE REPRODUCED OR DISCLOSED IN WHOLE OR IN PART OR USED FOR ANY PURPOSE EXCEPT WHEN SUCH USER POSSESSES DIRECT WRITTEN AUTHORIZATION FROM REDGUARD, LLC

EXPORT CONTROLLED DATA: THIS DOCUMENT MAY CONTAIN TECHNICAL INFORMATION WHOSE EXPORT IS GOVERNED BY THE UNITED STATES DEPARTMENTS OF COMMERCE AND STATE. IT IS THE RESPONSIBILITY OF THE RECIPIENT(S) OF THIS DRAWING TO ENSURE THAT ITS CONTENTS ARE CONTROLLED AS SUCH TO REMAIN IN COMPLETE COMPLIANCE WITH THE U.S. ARMS EXPORT CONTROL ACT, THE INTERNATIONAL TRAFFIC IN ARMS REGULATIONS, AND THE EXPORT ADMINISTRATION ACT.



4817 S LEWIS ST.  
 NEW IBERIA, LA 70560  
 PH: 504.588.2551  
[www.armoda.com](http://www.armoda.com)

STABBERT MARITIME

12' X 42' X 10'-6"

FLOOR PLAN

CP#: A-036

PROJECT MANAGER: TM

DRAWN BY: JR

DATE: 9/9/2025

FILE: A-036 12X42 FP

SCALE: 1/2" = 1'-0"

REVISION: A

SHEET: A1.1

**A-036 STABBERT MARITIME  
 FLOOR PLAN - Q# 300113  
 12' X 42' X 10'-6"**

**SCALE LISTED IS VALID  
 ONLY FOR "D" SIZE PAPER  
 (36" X 24")**