

REVISION HISTORY				
REV	DESCRIPTION	DATE	BY	CHECKED
A	ISSUED FOR REVIEW	10/16/2024	JR	TM
B	UPDATED PER INTERNAL COMMENTS	2/3/2025	JR	TM

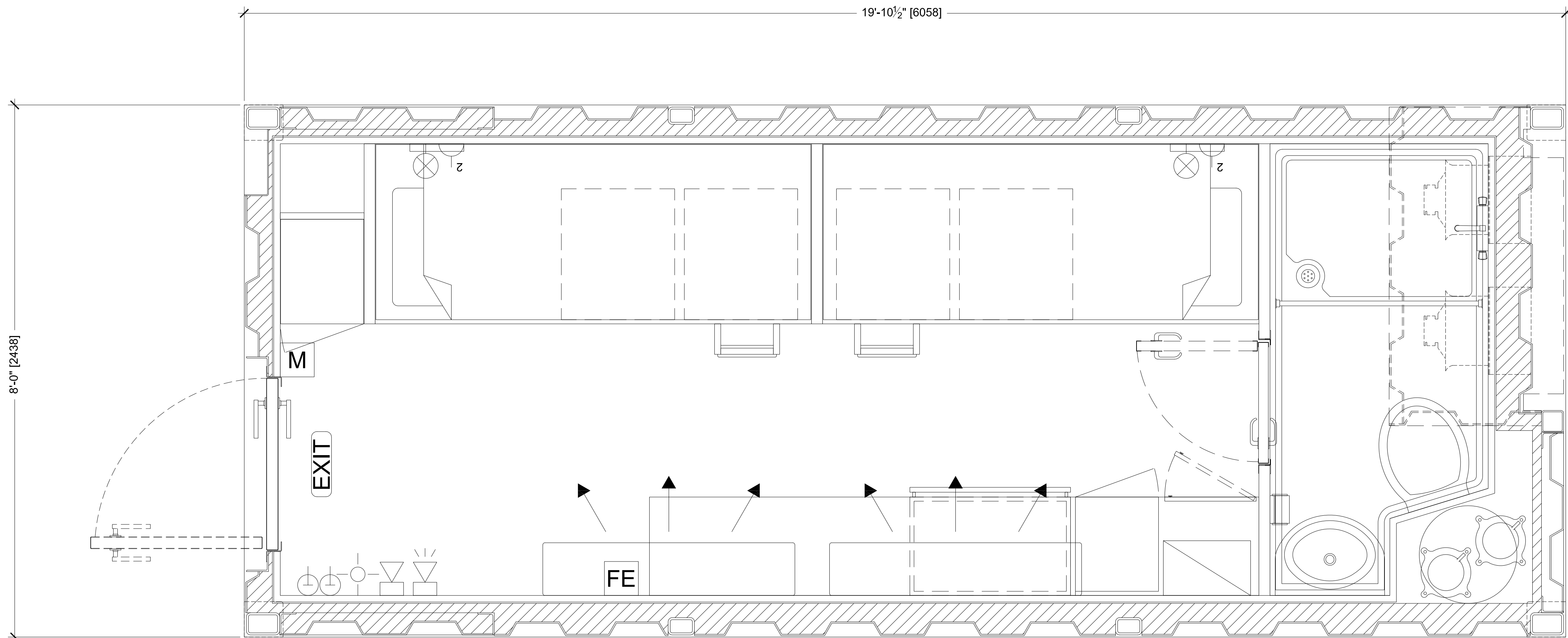

THE INFORMATION CONTAINED HEREIN IS PROPRIETARY TO REDGUARD, LLC AND SHALL NOT BE REPRODUCED OR DISCLOSED IN WHOLE OR IN PART OR USED FOR ANY PURPOSE EXCEPT WHEN SUCH USER POSSESSES DIRECT WRITTEN AUTHORIZATION FROM REDGUARD, LLC

EXPORT CONTROLLED DATA: THIS DOCUMENT MAY CONTAIN TECHNICAL INFORMATION WHOSE EXPORT IS GOVERNED BY THE UNITED STATES DEPARTMENTS OF COMMERCE AND STATE. IT IS THE RESPONSIBILITY OF THE RECIPIENT(S) OF THIS DRAWING TO ENSURE THAT ITS CONTENTS ARE CONTROLLED AS SUCH TO REMAIN IN COMPLETE COMPLIANCE WITH THE U.S. ARMS EXPORT CONTROL ACT, THE INTERNATIONAL TRAFFIC IN ARMS REGULATIONS, AND THE EXPORT ADMINISTRATION ACT.



2317 ENGINEERS RD.  
 BELLE CHASSE, LA 70037  
 PH: 504.588.2551  
 www.armoda.com

ARMODA  
 8' X 19'-10 1/2" X 9'-6"  
 FLOOR PLAN

CP#: FLEX 20  
 PROJECT MANAGER: TM  
 DRAWN BY: JR  
 DATE: 10/16/2024  
 FILE: FLEX 20 8X20 ACCOMMODATION FP  
 SCALE: 1" = 1'-0"  
 REVISION: B  
 SHEET: A1.1

**FLEX 20 ARMODA  
 FLOOR PLAN - 4 MAN ACCOMMODATION  
 8' X 19'-10 1/2" X 9'-6"**

SCALE LISTED IS VALID  
 ONLY FOR "D" SIZE PAPER  
 (36" X 24")