

REVISION HISTORY				
REV	DESCRIPTION	DATE	BY	CHECKED
A	ISSUED FOR REVIEW	7/18/2024	JR	TM
B	UPDATED DRAWING TO LATEST STANDARDS	9/25/2024	JR	TM
C	UPDATED PER INTERNAL COMMENTS	1/31/2025	JR	TM

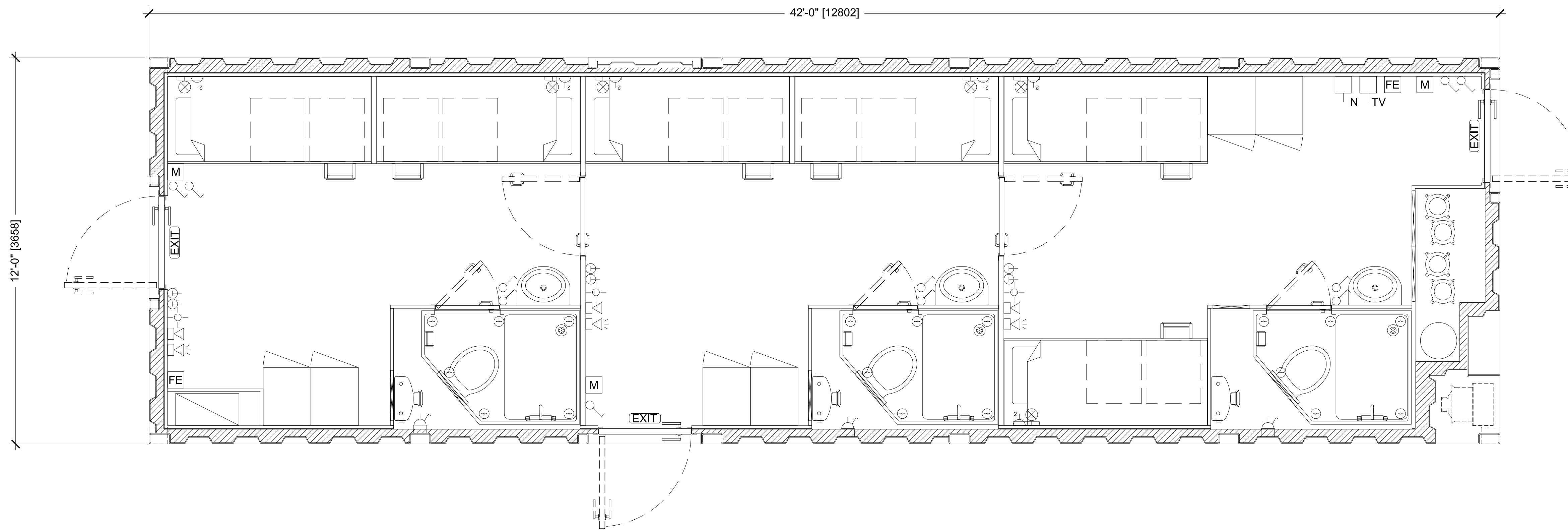

THE INFORMATION CONTAINED HEREIN IS PROPRIETARY TO REDGUARD, LLC AND SHALL NOT BE REPRODUCED OR DISCLOSED IN WHOLE OR IN PART OR USED FOR ANY PURPOSE EXCEPT WHEN SUCH USER POSSESSES DIRECT WRITTEN AUTHORIZATION FROM REDGUARD, LLC

EXPORT CONTROLLED DATA: THIS DOCUMENT MAY CONTAIN TECHNICAL INFORMATION WHOSE EXPORT IS GOVERNED BY THE UNITED STATES DEPARTMENTS OF COMMERCE AND STATE. IT IS THE RESPONSIBILITY OF THE RECIPIENT(S) OF THIS DRAWING TO ENSURE THAT ITS CONTENTS ARE CONTROLLED AS SUCH TO REMAIN IN COMPLETE COMPLIANCE WITH THE U.S. ARMS EXPORT CONTROL ACT, THE INTERNATIONAL TRAFFIC IN ARMS REGULATIONS, AND THE EXPORT ADMINISTRATION ACT.



ARMODA

2317 ENGINEERS RD.
 BELLE CHASSE, LA 70037
 FAX: 316.440.1800
 www.armoda.com

ARMODA

12' X 42' X 10'-6"

FLOOR PLAN

CP#: FLEX 42

PROJECT MANAGER: TM

DRAWN BY: JR

DATE: 7/18/2024

FILE: FLEX 42 12X42 ACCOMMODATION

SCALE: 1/2" = 1'-0"

REVISION: C

SHEET: A1.1

**FLEX 42 ARMODA
 FLOOR PLAN - 12 MAN ACCOMMODATION
 12' X 42' X 10'-6"**

**SCALE LISTED IS VALID
 ONLY FOR "D" SIZE PAPER
 (36" X 24")**