

REVISION HISTORY				
REV	DESCRIPTION	DATE	BY	CHECKED
A	ISSUED FOR REVIEW	8/9/2024	JR	JLL

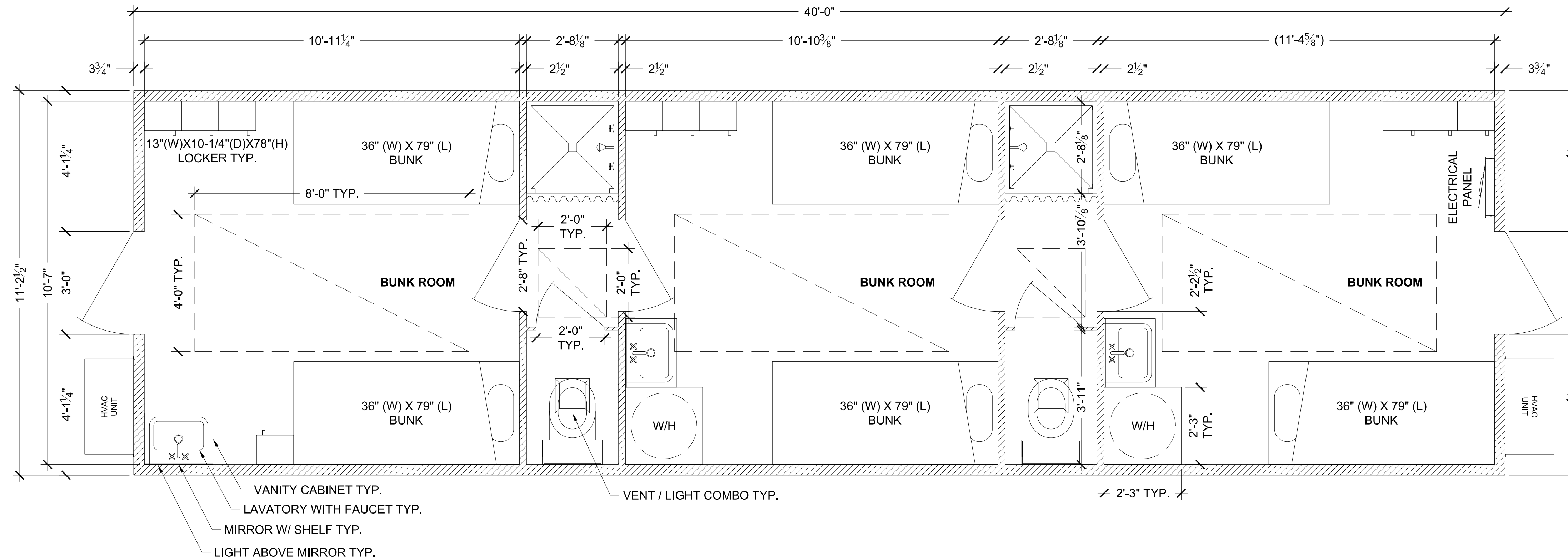

THE INFORMATION CONTAINED HEREIN IS PROPRIETARY TO REDGUARD, LLC AND SHALL NOT BE REPRODUCED OR DISCLOSED IN WHOLE OR IN PART OR USED FOR ANY PURPOSE EXCEPT WHEN SUCH USER POSSESSES DIRECT WRITTEN AUTHORIZATION FROM REDGUARD, LLC

EXPORT CONTROLLED DATA: THIS DOCUMENT MAY CONTAIN TECHNICAL INFORMATION WHOSE EXPORT IS GOVERNED BY THE UNITED STATES DEPARTMENTS OF COMMERCE AND STATE. IT IS THE RESPONSIBILITY OF THE RECIPIENT(S) OF THIS DRAWING TO ENSURE THAT ITS CONTENTS ARE CONTROLLED AS SUCH TO REMAIN IN COMPLETE COMPLIANCE WITH THE U.S. ARMS EXPORT CONTROL ACT, THE INTERNATIONAL TRAFFIC IN ARMS REGULATIONS, AND THE EXPORT ADMINISTRATION ACT.



2317 ENGINEERS RD.  
 BELLE CHASSE, LA 70037  
 FAX: 316.440.1800  
 www.armoda.com

MATTHEWS  
 11'-2 1/2" X 40' X 10'-6"  
 FLOOR PLAN

RP#: 052  
 PROJECT MANAGER: DP  
 DRAWN BY: JR  
 DATE: 8/9/2024  
 FILE: RP 052 11X40 FP  
 SCALE: 1/2" = 1'-0"  
 REVISION: A  
 SHEET: A1.1

**RP# 052 MATTHEWS  
 FLOOR PLAN - 12 MAN SLEEPER  
 11'-2 1/2" X 40' X 10'-6"**

- NOTES:**
- ALL INTERIOR LIGHTS TO BE CENTERED IN ROOMS
  - INTERIOR CEILING HEIGHT 90-1/4" FROM FINISHED FLOOR W/ 2X2 DROP TILE
  - E-LIGHTS IN ALL BUNK ROOMS

**SCALE LISTED IS VALID  
 ONLY FOR "D" SIZE PAPER  
 (36" X 24")**